

# KIT XTRACK

TRRS XTRACK

**RRR**  
RAGA RACING

300-280-250-125

2021



*This kit is a competition accessory only and is not manufactured for, nor should it be used on public streets, roads or highways. The use of this kit should be limited to participation in sanctioned competition events upon a closed course.*

July 2020



**TRRS**  
MOTORCYCLES

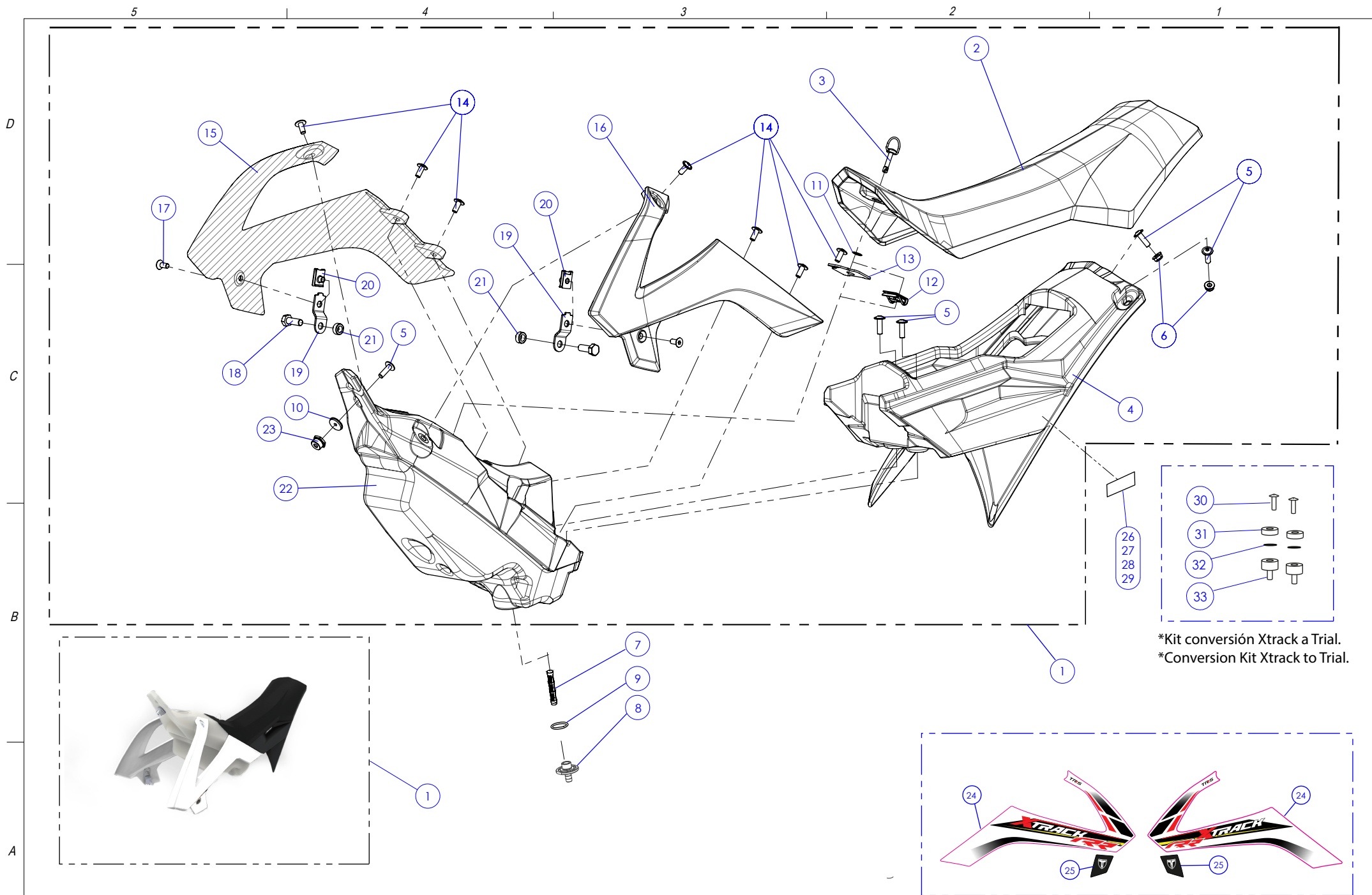

\*Kit conversión Xtrack a Trial.  
\*Conversion Kit Xtrack to Trial.

Sólo válido para carburador Keihin. Only suitable for Keihin carburetor.  
This kit is a competition accessory only and is not manufactured for, nor should it be used on public streets, roads or highways. The use of this kit should be limited to participation in sanctioned competition events upon a closed course.

XTRACK RR 2021 - TRRS Motorcycles

01	<b>17000TR201</b>	Conjunto X-Track RR	<i>XTrack Kit RR</i>	<b>1</b>
02	<b>17001TR100</b>	Asiento XTrack	<i>Seat XTrack</i>	<b>1</b>
03	<b>58018</b>	Cierre 1/4 de vuelta	<i>Quarter turn screw</i>	<b>1</b>
04	<b>17002TR100</b>	Subchasis Xtrack	<i>Subframe Xtrack</i>	<b>1</b>
05	<b>50211</b>	Tornillo M6x20	<i>Screw M6x20</i>	<b>5</b>
06	<b>51501</b>	Tuerca Autoblocante M6	<i>Locknut M6</i>	<b>2</b>
07	<b>70128</b>	Filtro gasolina roscado	<i>Fuel filter threaded</i>	<b>1</b>
08	<b>17014TR100</b>	Adaptador grifo deposito gasolina	<i>Fuel tap tank adapter</i>	<b>1</b>
09	<b>53022</b>	Junta tórica depósito 18x2 XTrack	<i>O-ring 18x2</i>	<b>1</b>
10	<b>56901</b>	Arandela Metal - Goma Depósito Gasolina - Aparece en la lámina 06 despiece XTRACK RR	<i>Washer, rubber-metal, fuel tank - Appears in drawing 06 - XTRACK RR</i>	-
11	<b>58019</b>	Reten a presión acero inoxidable	<i>Panex retainer quarter turn screw</i>	<b>1</b>
12	<b>58017</b>	Grapa cierre 1/4 de vuelta	<i>Quarter turn clamp</i>	<b>1</b>
13	<b>17009TR100</b>	Soporte delantero asiento	<i>Seat front support</i>	<b>1</b>
14	<b>50209</b>	Tornillo M6x14	<i>Screw M6x14</i>	<b>7</b>
15	<b>17004TR100</b>	Aleta derecha Xtrack	<i>Spoiler Xtrack right side</i>	<b>1</b>
16	<b>17003TR100</b>	Aleta izquierda Xtrack	<i>Spoiler Xtrack left side</i>	<b>1</b>
17	<b>50302</b>	Tornillo Avellanado M6x14	<i>Bolt DIN-7991 M6x14</i>	<b>2</b>
18	<b>50504</b>	Tornillo M8x22	<i>Bolt M8x22</i>	<b>2</b>
19	<b>17018TR100</b>	Soporte aleta XTrack	<i>Support Spoiler XTrack</i>	<b>2</b>
20	<b>51301</b>	Grapa M6	<i>Clip-nut, M6</i>	<b>2</b>
21	<b>17008TR100</b>	Separador soporte aleta	<i>Spacer spoiler support</i>	<b>2</b>
22	<b>17006TR101</b>	Depósito gasolina Xtrack translúcido	<i>Fuel tank Xtrack translucid</i>	<b>1</b>
23	<b>17017TR100</b>	Adaptador deposito / chasis	<i>Adapter fuel tank / frame</i>	<b>1</b>
24	<b>15072TR122</b>	Adhesivo Aleta XTrack	<i>Sticker, Spoiler Xtrack</i>	<b>1</b>
25	<b>15067TR104</b>	Adhesivo Aleta Inferior XTrack	<i>Sticker, lower spoiler Xtrack</i>	<b>1</b>
26	<b>15068TR113</b>	Juego adhesivos cilindrada - 125	<i>Sticker, engine size 125</i>	<b>1</b>
27	<b>15068TR114</b>	Juego adhesivos cilindrada - 250	<i>Sticker, engine size 250</i>	<b>1</b>
28	<b>15068TR115</b>	Juego adhesivos cilindrada - 280	<i>Sticker, engine size 280</i>	<b>1</b>
29	<b>15068TR116</b>	Juego adhesivos cilindrada - 300	<i>Sticker, engine size 300</i>	<b>1</b>
30	<b>50202</b>	Tornillo M6x16	<i>Screw M6x16</i>	<b>2</b>
31	<b>17019TR100</b>	Distanciador 6x20x5	<i>Spacer 6x20x5</i>	<b>2</b>
32	<b>53023</b>	Tórica 5,5x1,5	<i>O`ring 5,5x1,5</i>	<b>2</b>
33	<b>63003</b>	Silentblock 20x10 M6	<i>Silentblock 20x10 M6</i>	<b>2</b>

This kit is a competition accessory only and is not manufactured for, nor should it be used on public streets, roads or highways. The use of this kit should be limited to participation in sanctioned competition events upon a closed course.